

## Processing Credit & Debit Cards

The new EFTPOS terminal will automatically recognise and accept various forms of payment, including physical and digital Bank Cards, Cabcharge, and Taxi Subsidy Scheme cards.

After ending the trip, the EFTPOS terminal will display the final fare and prompt your passenger to make their payment.

- **Bank Card (Debit / Credit Card)**

Simply tap the card or phone on the contactless reader situated at the top of the EFTPOS terminal.

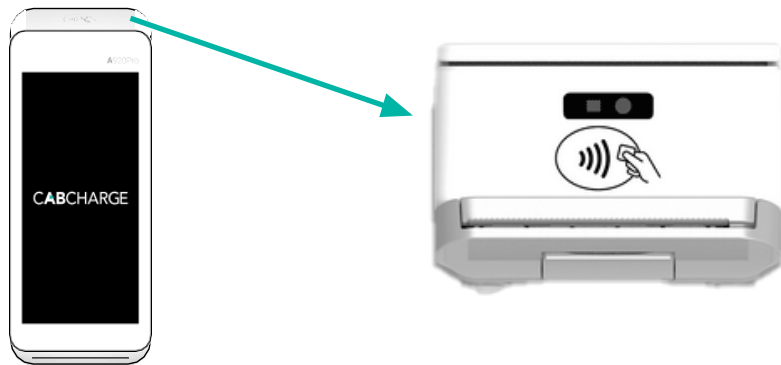

Physical bank cards also support the **SWIPE** or **INSERT** function. To use this feature, simply swipe or insert card in the **swipe or chip card reader**.

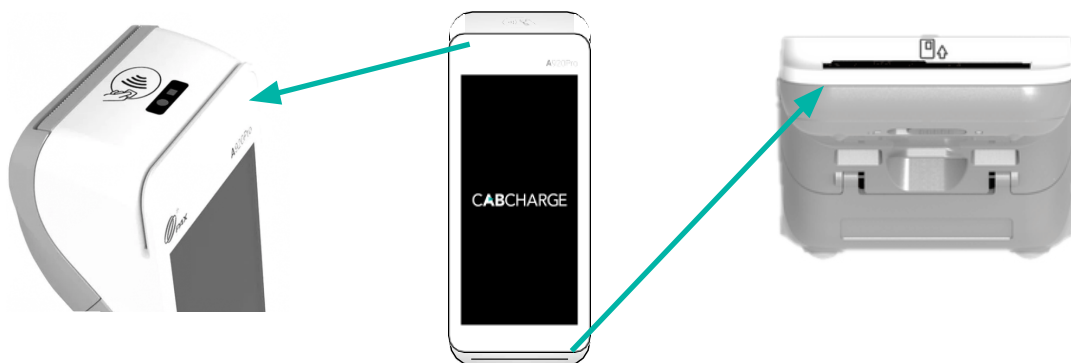

**Once approved**, remove the card if inserted and press '**OK**' to print passenger receipt.